

WHAT'S IN THE BOX

Inside the package you should find:

Number of pieces	Components
1 pc.	Dynamic Displacement Sensor
1 pc.	Antenna
2 pcs.	Anchors (M6x25mm, fixing hole 8mm)
2 pcs.	Socket cap screws (M6x30mm)
1 pc.	This guide

Carefully examine what's inside the package and check that everything is present and in excellent condition.

! **DO NOT** unbox the Dynamic Displacement Sensor in a dusty and/or humid environment. The IP rating of the product is guaranteed only after the antenna is screwed tightly on and the serial connector has a cable connected or the supplied lid on.

! **DO NOT** loosen or tighten the screws of the Dynamic Displacement Sensor's case, as this could alter the product's IP rating.

BEFORE THE INSTALLATION

Check that you have the right tools for the operation.

1. A drill of suitable size
2. An electric screwdriver of suitable size
3. A level



1. POSITIONING AND ORIENTATION

Before installing the Dynamic Displacement Sensor, make sure you have the right version (vertical or horizontal). The ones described below are the **ONLY** allowed orientations, installing the device in any other way may compromise its effectiveness.

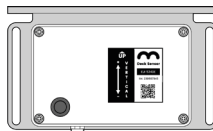

VERTICAL (DECK002-V)



HORIZONTAL (DECK002-H)

VERTICAL

The vertical version of the Dynamic Displacement Sensor must **ALWAYS** be installed with the positive side facing upwards, as reminded by the word **UP** surmounted by an arrow pictured on the label.

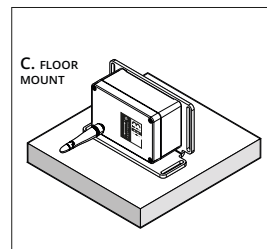
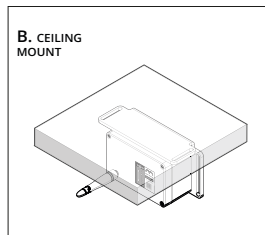
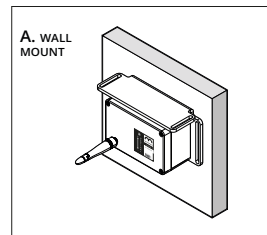

To mount a vertical Dynamic Displacement Sensor on the floor (C.) the user must rotate the mounting plate so that the **UP** sign on the label is correctly pointing upwards.

Check the Instruction Manual for the complete procedure.

HORIZONTAL

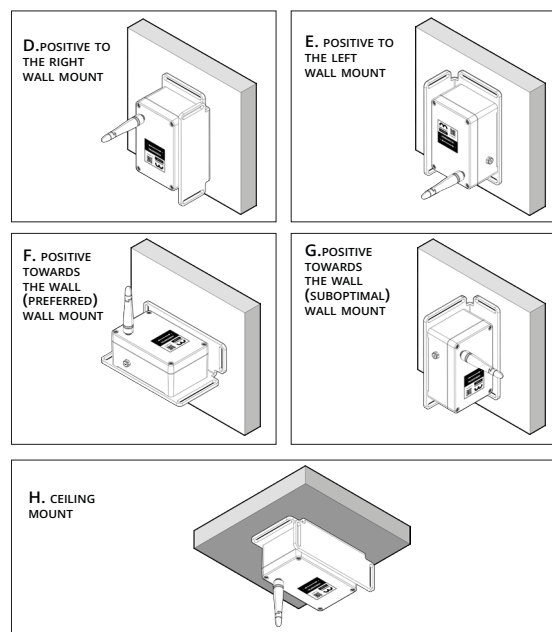

2. INSTALLATION

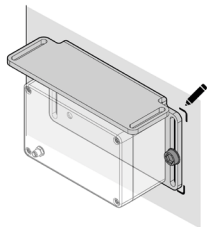

1. Using the installation plate as reference, mark the chosen spot.

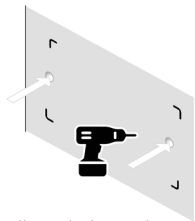

2. Drill two holes in the mounting surface.

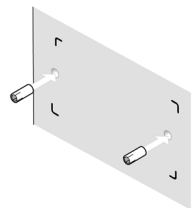

3. Insert the two brass anchors in the holes.

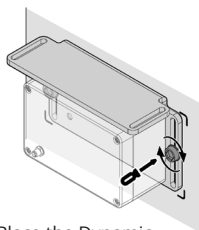

4. Place the Dynamic Displacement Sensor on the structure and loosely tighten the two screws.

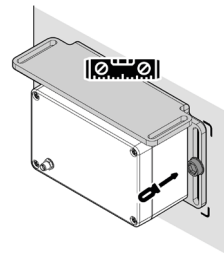

5. Using a level, make sure that the sensor is as horizontal as possible. The plate allows for slight corrections in inclination. Tighten the screws to lock in place.

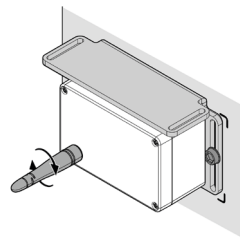

6. If the antenna was not already installed (advised to protect the sensor from humidity), tightly screw on the antenna.

- ⓘ This procedure is valid for all the orientations.
A. WALL MOUNT - VERTICAL used as an example.
- ⓘ Make sure the surface where the Dynamic Displacement Sensor is going to be installed does not have asperities and protrusions. Close, stable and tight contact of the device with the surface is crucial to detecting accurate data.

SCAN THE QR CODE AND
DOWNLOAD THE COMPLETE
INSTRUCTION MANUAL:



www.movesolutions.it/dynamic-displacement-sensor

Move S.p.A.
Piazza Cavour 7, 20121 Milan - Italy
Via Guglielmo Lippi Francesconi 1256/J, 55100 Lucca - Italy
P.IVA: 09887990969

Dynamic Displacement Sensor



QUICK GUIDE TO INSTALLATION

This guide is not meant to substitute the complete Instruction Manual, which includes complete explanations and safety warnings.